



SMART
HOME
LIGHTS

D | Montageanleitung • GB | Fitting instructions

833209

230V/50Hz ~

1xLED-Board 55V DC / 58W

nicht wechselbar / not changeable

 2,4GHz
10dBm



58W

5.800 lm



65W

2.600 lm

t

20.000h

T_k

2.700-5.000 K



15.000 x



< 0,5 s



dimnable with rrc

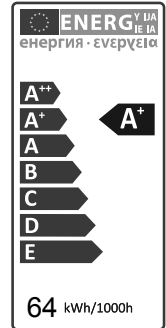

AAA, 1,5V

Inki. Funkfernbedienung

Incl. radio remote control



1 | Montage / fitting

als Pendelleuchte
as pendant light

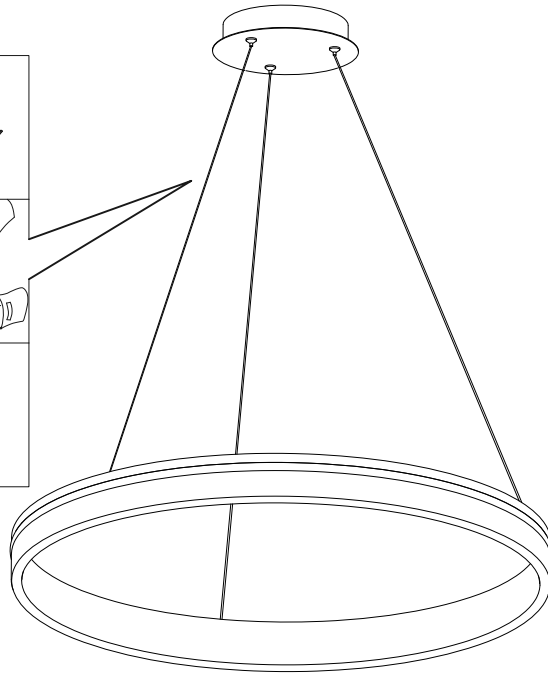
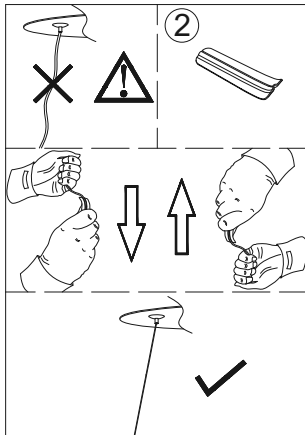
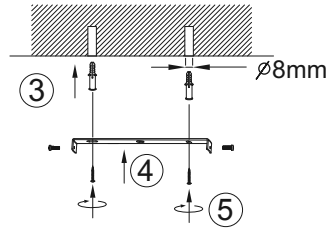
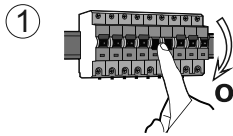

2 | Elektrischer Anschluss / electrical connection

230 Volt/50Hz~ Anschluss

230 Voltage/50Hz~ connection

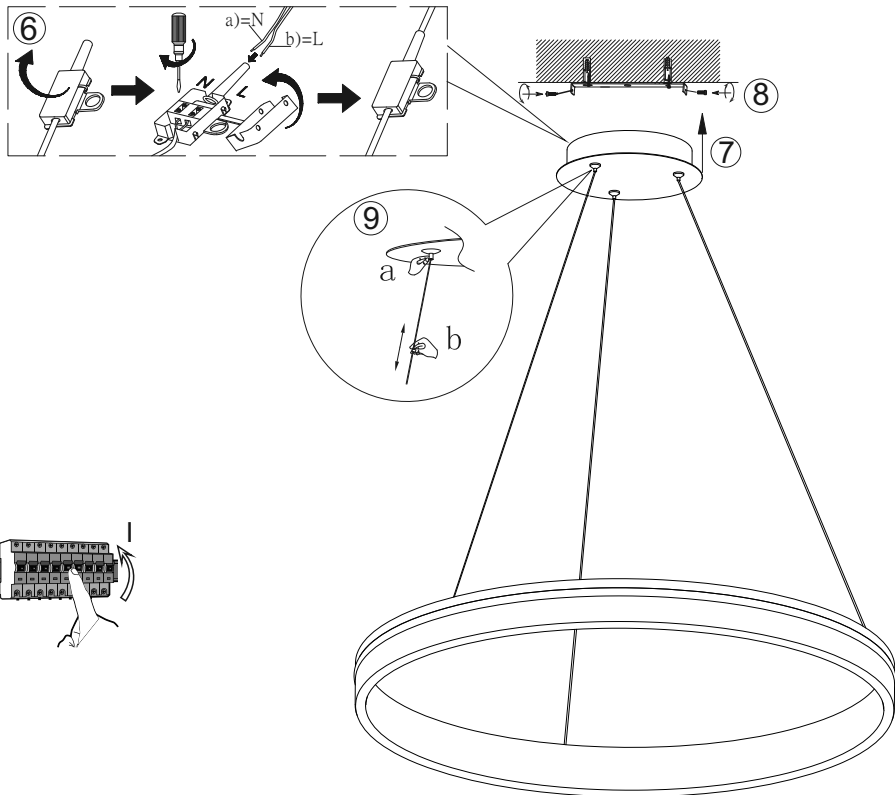

3 | Fernbedienung anlernen / teach remote control

Siehe Q-Fernbedienungsanleitung
See Q-remote control manual

Q-Empfänger (Antenne)
Q-receiver



13 Q-Fernbedienung
anlernen
Teach Q-remote
control

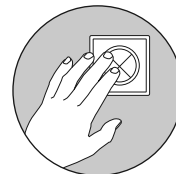

11 Leuchte einschalten
Switch on the lamp

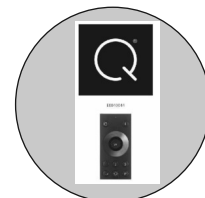

12 Bedienungsanleitung
lesen
Read instruction
manual



Reset

Rückstellen der Leuchte auf Werkseinstellung
Reset the lamp, factory new

5 x on/off

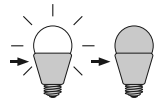
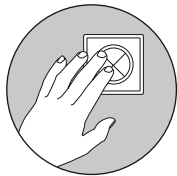

5-10 sec. 1-2 sec.

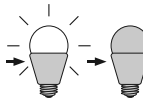

1-2 sec.

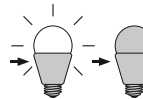

1-2 sec.

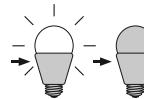

1-2 sec.



Das Gerät erfüllt die grundlegenden Anforderungen der Richtlinie 2014/53/EU (Radio Equipment Directive) des Europäischen Parlaments und des Rates der europäischen Union vom 16.04.2014 über Funkanlagen. Die vollständige Konformitätserklärung kann bei der unten stehenden Internet-Adresse aufgerufen werden.

This device fulfils the fundamental requirements of Directive 2014/53/EU (Radio Equipment Directive) of the European Parliament and of the Council of the European Union dated 16.04.2014 on items of radio equipment. The full declaration of conformity can be accessed at the Internet-address given below.

Paul Neuhaus

Paul Neuhaus GmbH
Olakenweg 36 · D-59457 Werl

Telefon: +49 (0) 2922-97 21-0

Telefax: +49 (0) 2922-97 21-9120

E-mail: kundenservice@neuhaus-group.de

<https://scm.paul-neuhaus.de/public/conformity/>